



VI SEC 3R12

On-the-dot dosage with maximum volumetric precision

RANGE OF USES:

- abrasive media
- adhesives
- silicones
- sealing compounds
- fats
- oils

DESCRIPTION:

The internal geometry of the stator is based on the eccentric screw pump systems. New manufacturing processes and materials make it possible to transform the complex geometry into this small design. Media in very small quantities can be conveyed fully volumetrically forward and backward.

TECHNICAL DATA:

| | |
|--------------------------------|---|
| Dimensions | Ø 29,95 mm x 100 mm |
| Weight | ca. 188 gram |
| Dosing volume | ca. 2,30 cc/rev |
| Dosing accuracy ⁽¹⁾ | ± 1% |
| Repeatability | > 99% |
| Min. dosing quantity | ca. 0,192 cc |
| Volume flow ⁽²⁾ | 2,30 to 276 cc/min |
| Min. operating pressure | 0 bar |
| Max. operating pressure | 0 to 6 bar |
| Max. dosing pressure | 21 bar |
| Available materials | Stainless steel / hi-pro / hi-per Item no. P03.3R12 / P04.3R12 Stainless steel / hi-act and hi-max Item no. P05.3R12 |

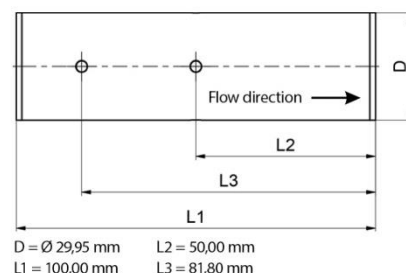

- (1) Volumetric dosing is related as absolute deviation to one revolution of the dispenser. Depends on the viscosity of the dosing medium.
 (2) Volume flow is dependent on viscosity and primary pressure.

All trademarks and product names mentioned are the property of their respective owners or manufacturers and are used here only to illustrate the purpose and suitability of VI SEC products.